

TOP VIEW

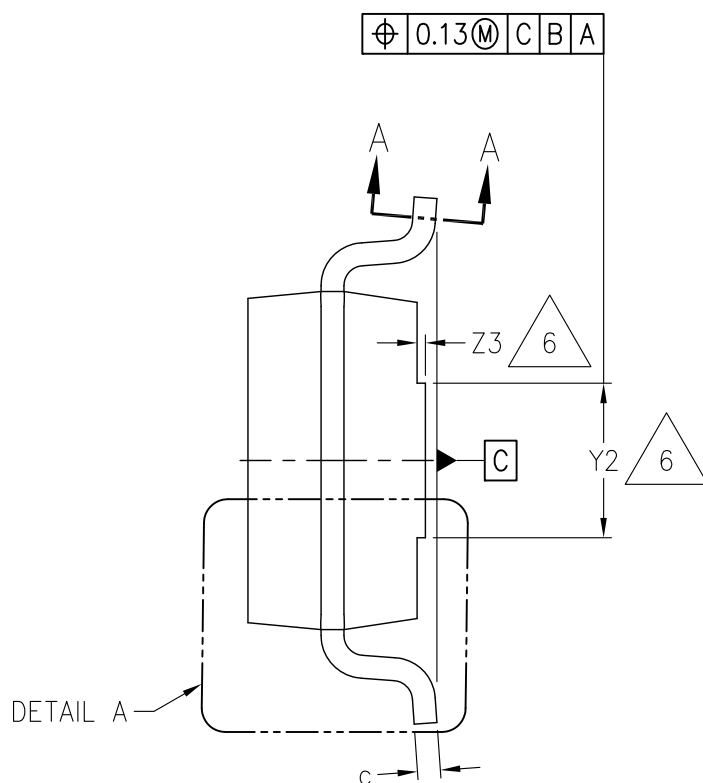

FRONT VIEW

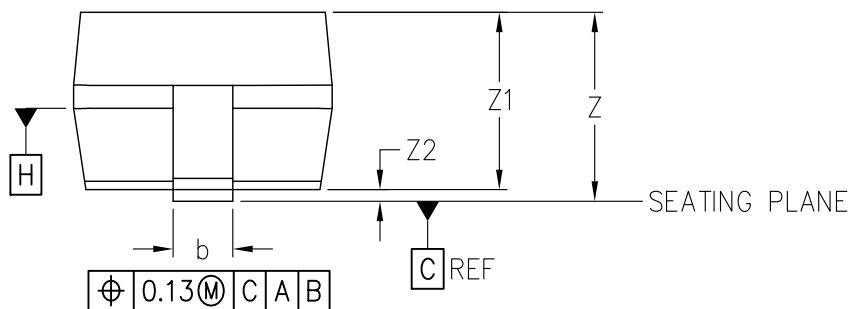

SIDE VIEW

JEDEC SOLID STATE  
PRODUCT OUTLINE  
Copyright © 2024 JEDEC

THIS **REGISTERED OUTLINE** HAS BEEN PREPARED BY THE JEDEC JC-11 COMMITTEE  
AND REFLECTS A PRODUCT WITH ANTICIPATED USAGE IN THE ELECTRONICS INDUSTRY;  
CHANGES ARE LIKELY TO OCCUR.

TITLE PLASTIC DUAL DISCRETE  
GULL WING, 1.00 MM PITCH,  
RECTANGULAR PACKAGE (DIODE)

PACKAGE DESIGNATOR  
P-PDSO-G2...

NUMBER  
DO-215

ISSUE  
E

DATE  
MAY 2024

SHEET  
1 OF 5

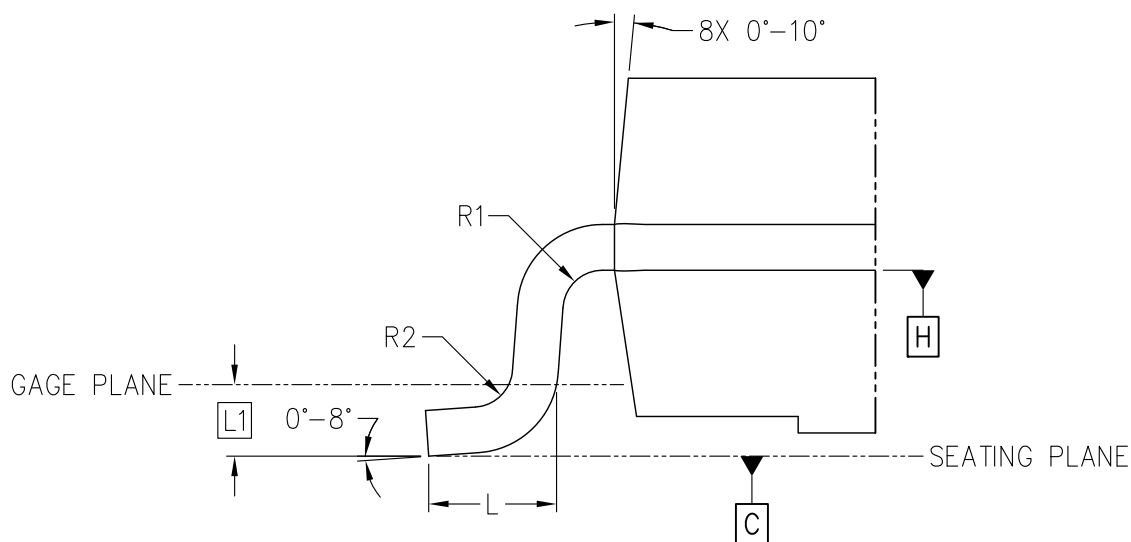

DETAIL A  
ROTATED 90° CW

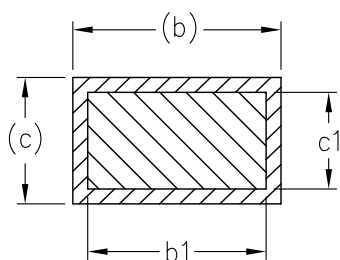

SECTION A-A 

TABLE 1

VARIATIONS										
SYMBOL	AA			AB			AC			NOTES
	---			---			---			
	MIN	NOM	MAX	MIN	NOM	MAX	MIN	NOM	MAX	
Z	1.95	2.30	2.65	1.95	2.30	2.65	1.95	2.40	2.90	
Z1	1.90	2.15	2.45	1.90	2.15	2.45	1.90	2.30	2.70	
Z2	0.05	0.15	0.20	0.05	0.15	0.20	0.05	0.15	0.20	
Z3	---	---	0.51	---	---	0.51	---	---	0.51	6
b	1.95	---	2.20	2.90	---	3.20	1.25	---	1.65	4
b1	1.95	2.05	2.10	2.90	3.00	3.10	1.25	1.40	1.55	4
c	0.15	---	0.41	0.15	---	0.41	0.15	---	0.41	4
c1	0.15	0.23	0.31	0.15	0.23	0.31	0.15	0.23	0.31	4
X	3.30	3.60	3.95	5.55	5.90	6.25	2.25	2.60	2.95	3, 5
Y	5.95	6.20	6.50	9.65	9.90	10.20	5.70	6.10	6.50	
Y1	4.05	4.30	4.60	6.60	6.85	7.15	4.05	4.30	4.60	3, 5
Y2	1.65	1.90	2.15	4.40	4.55	4.70	1.40	1.65	1.90	6
L	0.30	0.60	0.90	0.55	0.80	1.05	0.30	0.60	0.90	
L1	---	0.45	---	---	0.45	---	---	0.45	---	
R1	0.15	---	---	0.15	---	---	0.15	---	---	
R2	0.15	---	---	0.15	---	---	0.15	---	---	
NOTES	1, 2			1, 2			1, 2			
REF	11.1–655(E), 11–1043			11.1–655(E), 11–1043			11.1–655(E), 11–1043			
ISSUE	–			–			–			

TABLE 2

VARIATIONS										
SYMBOL	BA			AD			AE			NOTES
	---			---			P-PDSO-G2-I2p325-R1p3x1p675Z1p2-N2p65T0p325			
	MIN	NOM	MAX	MIN	NOM	MAX	MIN	NOM	MAX	
Z	2.35	2.95	3.50	1.05	1.20	1.35	---	---	1.20	
Z1	2.30	2.80	3.30	0.90	1.10	1.30	0.80	---	1.10	
Z2	0.05	0.15	0.20	0.05	0.10	0.15	---	---	0.10	
Z3	---	---	0.51	0.00	0.00	0.00	0.00	0.00	0.00	6
b	1.00	---	1.70	0.45	---	0.70	0.25	---	0.40	4
b1	1.00	1.30	1.60	0.45	0.55	0.65	0.23	---	0.36	4
c	0.15	---	0.41	0.10	---	0.20	0.08	---	0.25	4
c1	0.15	0.23	0.31	0.10	0.12	0.15	0.06	---	0.21	4
X	2.00	2.60	3.30	1.40	1.55	1.70	1.15	---	1.45	3, 5
Y	5.70	6.20	6.50	3.55	3.70	3.85	2.30	2.65	2.75	
Y1	3.95	4.45	4.95	2.55	2.70	2.85	1.45	---	1.90	3, 5
Y2	1.65	1.90	2.15	0.00	0.00	0.00	0.00	0.00	0.00	6
L	0.30	0.60	0.90	0.20	0.25	0.30	0.15	---	0.45	
L1	---	0.45	---	---	0.45	---	---	0.20	--	
R1	0.15	---	---	0.10	---	---	0.08	---	---	
R2	0.15	---	---	0.10	---	---	0.10	---	---	
NOTES	1, 2			1, 2			1, 2			
REF	11.1-655(E), 11-1043			11.1-655(E), 11-1043			11-1043			
ISSUE	-			-			-			

NOTES:

- 1. DIMENSIONING AND TOLERANCING PER ASME Y14.5–1994.
- 2. ALL DIMENSIONS ARE IN MILLIMETERS.

3 DIMENSIONS X AND Y1 DO NOT INCLUDE MOLD FLASH.  
MOLD FLASH SHALL NOT EXCEED 0.13 MM PER SIDE.

4 DIMENSIONS b1 AND c1 APPLY TO BASE METAL ONLY.  
DIMENSIONS b AND c APPLY TO PLATED TERMINALS.  
DIMENSIONS b, c, b1, c1 TO BE MEASURED ON FLAT SECTION OF THE TERMINAL,  
BETWEEN 0.13 MM AND 0.25 MM FROM TERMINAL TIP.

5 DIMENSIONS X AND Y1 TO BE DETERMINED AT DATUM PLANE H.

6 PEDESTAL (Y2 AND Z3) IS AN OPTIONAL FEATURE.

7 POLARITY INDICATION TO BE WITHIN HATCHED AREA.

STP (3D) FILE RECORD

3D FILE NAMES MAY EXCEED LENGTH REQUIREMENTS FOR SOME SOFTWARE TOOLS.

STP FILE NAME	DATE	ITEM NUMBER
DO-215E-AE_P-PDSO-G2-I2p325-R1p3x1p675Z1p2-N2p65T0p325	MAY 2024	11-1043

TASK GROUP CONTRIBUTORS

TEXAS INSTRUMENTS INC.

# CHANGE RECORD

IF THE CHANGE INVOLVES ANY WORDS ADDED OR DELETED (EXCLUDING DELETION OF ACCIDENTALLY REPEATED WORDS), THE CHANGE IS TO BE INCLUDED BELOW. PUNCTUATION CHANGES MAY OR MAY NOT BE INCLUDED.

INITIAL ISSUE: A	DATE: JUNE 1987	ITEM NUMBER: 10-239
------------------	-----------------	---------------------

CHANGE RECORD HISTORY:
------------------------

ISSUE: B	DATE: MARCH 1991	ITEM NUMBER: 10-301
----------	------------------	---------------------

ISSUE: C	DATE: SEPTEMBER 1996	ITEM NUMBER: 10-364
----------	----------------------	---------------------

ISSUE: D	DATE: APRIL 2003	ITEM NUMBER: 11.1-655(E)
----------	------------------	--------------------------

ISSUE: E	DATE: MAT 2024	ITEM NUMBER: 11-1043
LOCATION:	CHANGED FROM:	CHANGED TO:
ALL SHEETS		UPDATED TO CURRENT FORMAT AND STANDARDS
ALL SHEETS	SMALL OUTLINE PLASTIC SURFACE MOUNT GULL WING	PLASTIC DUAL DISCRETE GULL WING 1.00 MM PITCH RECTANGULAR PACKAGE (DIODE)
SHEET 1		ADDED SECTION A-A
		ADDED POLARITY MARK AREA
	PDS0-G2...	P-PDS0-G2...
SHEETS 1, 3, 4, & 5	D, E, AND A	X, Y, AND Z RESPECTIVELY
SHEET 2	DRAFT ANGLE 0°-8°	DRAFT ANGLE 0°-10°
		ADDED L1 FOR GAGE PLANE
SHEETS 3 & 4		ADDED L1 TO TABLES
		ADDED VARIATION AE
SHEET 5	NOTE 4: LEADS	NOTE 4: TERMINALS
		ADDED NOTE 7